

Help Us Create a Modernized Ida B. Wells High School



The Plan for the New School

The brand-new school will feature state-of-the-art academic and support spaces. The swimming pool will remain in its current location and is not part of the renovation.

Plan Highlights

- Specialized instructional classrooms include computer science, engineering, robotics, sound engineering, journalism, occupational health, and business management programs.
- The performing arts facilities include a 500-seat theater, dedicated band and choir spaces, and a black box teaching theater.
- Updated athletics spaces include a 1,700-seat main gym, auxiliary gym, weight room and wrestling room.
- The site upgrades include new turf fields, new tennis courts, improved bus and parking lot access with landscaped walkways and covered bike parking. The number of parking spaces will remain about the same.

Summer 2025 Update

Following the school board's direction to reduce costs, the project team has developed an updated design that maintains the academic, athletic, and extracurricular spaces that all modernized PPS high schools have. The cost reductions have resulted in an optimized building layout that simplifies the structural and heating/cooling systems. The project team has worked diligently to realize savings while keeping design features that were prioritized by the IBW community.

Front entry rendering

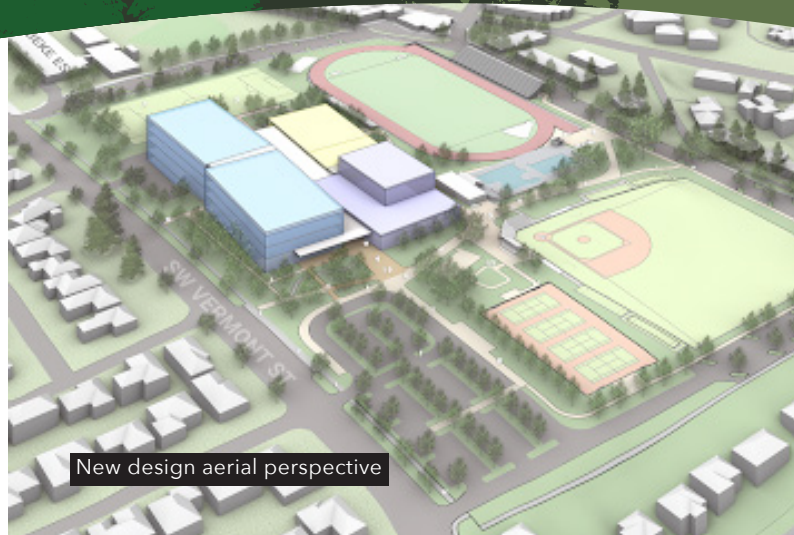

New design aerial perspective

A Focus on Community Engagement

The IBW design plan was developed through extensive community engagement, including multiple Comprehensive Planning Committee & Design Advisory Group meetings, Community Design Workshops, meetings with IBW teachers, staff and students, presentations to nearby community organizations, and outreach to individuals and groups that have been historically under-served.

Get Involved

More design workshops will be held in the coming months. Visit the project website for more information.

Construction Schedule

A construction schedule for Ida B. Wells is under development. More information will be available in the coming months. During the construction period, Ida B. Wells students and staff will remain on campus while the new building is constructed. Visit the project website for more information.

Ida B Wells modernization website

Visit the website pps.net/IdaBWellsBond for the latest developments and a list of upcoming engagement opportunities.

